

Job Name

Purchaser

Submitted to

Unit Designation

Location

Engineer

Reference

Schedule #

Approval

Construction

Specifications			
Model	Indoor Unit Model Number		AC024MNADCH/AA
	Outdoor Unit Model Number		AC024MXSCCC/AA
Performance	Nominal Capacity	Btu/h	24,000
	Capacity Range	Btu/h	7,000 - 27,000
	SEER / EER		18.3 / 10.55
	AHRI Certification Number		10491545
Power	Voltage	ø / V / Hz	1 / 208-230 / 60
	Working Voltage Range (VAC)		176 - 254 (max. 3% deviation from each)
	Operating Current	min. / std. / max.	1.8 / 10.0 / 15.0
	Max. Breaker	Amps	20
Dimensions	Min. Circuit Ampacity (A)		16.0
	W X H X D (in.)	Indoor Unit	41 7/8 X 11 5/8 X 11 7/8
	Weight (lbs.)	Outdoor Unit	34 5/8 X 31 7/16 X 12 3/16
		Indoor Unit	32.19
Heat Exchanger	Indoor & Outdoor Unit Type		Aluminum Fin / Copper Tube
Sound Pressure Level	Indoor Unit dB(A)	(Silent) / L / M / H	32 / 35 / 39 / 43
	Outdoor Unit dB(A)	High	50
Operating Temperatures	Outdoor	°F(°C)	23 ~ 115°F(-5 ~ 46°C)
	Indoor	°F(°C)	-40 ~ 115°F(46°C) w/wind baffle
Pipe Connections	Indoor & Outdoor	High side (flare)	1/4"
		Low side (flare)	5/8"
	Maximum (ft.)		164
	Maximum Vertical Separation (ft.)		98
Refrigerant	Condensate Connection		11/16" OD
Compressor	Type		R410A
	Control Method		Electronic Expansion Valve
	Factory Charge	oz.	70.56
	Charged for		25 ft
Evaporator Fan	Additional Refrigerant		0.11 oz/ft over 25 ft
Condenser Fan	Manufacturer		Samsung
	Type		Inverter Driven, BLDC, Rotary
	RLA	Amps	10.5
Optional Accessories	Type		BLDC with Crossflow fan (1)
	Air Volume	CFM (L/M/H)	410 / 477 / 551
	Output (W) / FLA (A)		27 W / 0.70 A
Safety	Motor		BLDC With Axial Type Fan (1)
	FLA / W / CFM (max.)		0.9 A / 89 W / 1,801 CFM
Optional Accessories	Wired Controller	Simplified Touch Controller	MWR-SH11UN
		Advanced Wired Controller	MWR-WG00UN
	Condensate pump	Aspen Mini Orange	ASP-MO-UNIV 110-250
		Blue Diamond	BD-BLUE230
	Wi-Fi Adapter		MIM-H04UN
	External Temperature Sensor		MRW-TA
	External Contact Control		MIM-B14
	Central Control Interface Module for Connection to DVM Plus Controls (non-NASA)		MIM-N01
	Wall Bracket (for outdoor unit)		CKN-250
	Wind Baffles	Front	WBF-2M
		Back	WBB-7M
	Line Sets - insulated and flared, interconnect cables included		25' - ILS2509
Safety	50' - ILS5009		



- Wall-mounted evaporator
- Low ambient cooling to -40°
- The outdoor unit shall supply power to indoor unit via 14 AWG X 3 power wire
- Auto-restart after power loss
- The outdoor unit shall have a snow accumulation prevention option setting to prevent snow drifting against an idle outdoor unit.
- The indoor unit shall have a removable EEPROM that stores system programming information, unit name, and other data
- All indoor unit addressing and option settings shall be done digitally; the indoor unit does not contain rotary dials or setting switches.
- The outdoor unit shall have a night time quiet mode option to reduce operating sound during the night.

Construction
The outdoor unit shall be galvanized steel with a baked on powder coated finish for durability

Indoor unit chassis shall be UL94 V0 with a galvanized steel mounting plate

The indoor unit shall have easy-access to wire, pipe, and drain connections via access panel on front of unit for easier installation and service

Heat Exchanger
The indoor unit and outdoor unit heat exchangers shall be mechanically bonded aluminum fin to copper tube

Controls
Control signal shall be a DDC type signal

Advanced configuration options for high room temperature alerts using MIM-B14 external contact control to enable a backup system and/or to notify a BMS (refer to technical documents available at www.DVMdownload.com for full details).

Interconnect control wire between outdoor indoor unit shall be 16AWG X 2 shielded

Wired controls must be purchased separately

Wireless controller included

Connection to optional wired controllers shall be 2 X 16AWG shielded wire

Controls shall integrate with a BMS system

The system shall integrate with the Samsung NASA Controls Solution

No additional interface modules/adapters are required when connecting to Samsung NASA DVM S central control options (MIM-D01AUN, MIM-B17BUN, MIM-B18BUN, MCM-A300UN).

Refrigerant System
The refrigerant shall be R410A

The compressor shall be hermetically sealed, inverter controlled, BLDC Rotary

Refrigerant flow shall be controlled by an electronic expansion valve at outdoor unit

Soft-start to reduce current demand during compressor start

Warranty
7 Years compressor, 5 years parts with registration

Certified in accordance with the AHRI Unitary Small Air-Conditioners (USAC) Certification Program which is based on the latest edition of AHRI Standard 210/240.

Samsung HVAC maintains a policy of ongoing development, specifications are subject to change without notice. Refer to www.AHRIdirectory.org for current reference numbers.

Notice: US Federal law requires that the above model to be installed in all U.S. states and territories except in AZ, CA, NM, and NV. Federal law prohibits installation of this unit in these states.

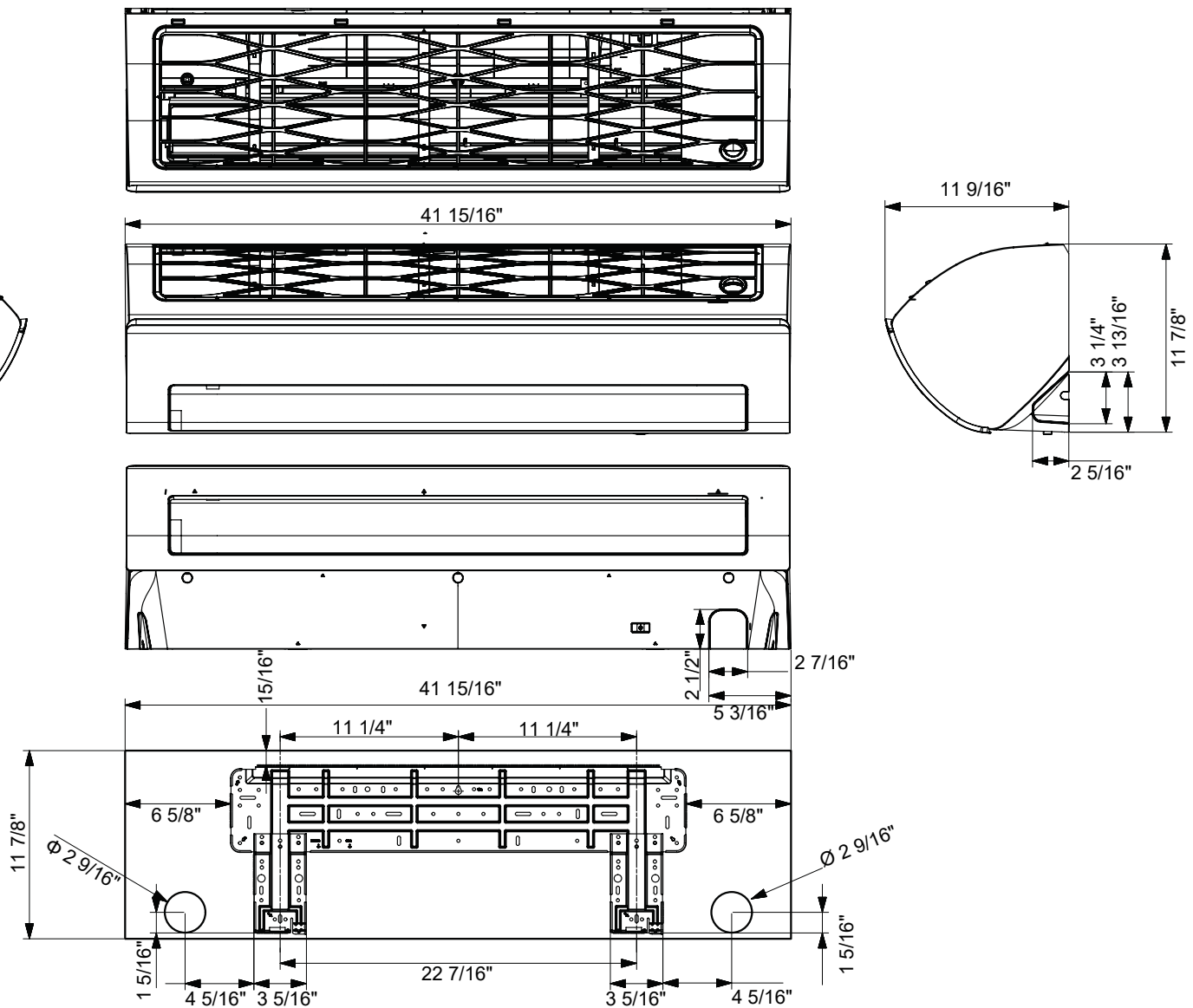

No.	Name	Description
1	Liquid pipe connection	1/4"
2	Gas pipe connection	5/8"
3	Drain pipe connection	11/16" OD
4	Power supply & Communication wiring conduit	-

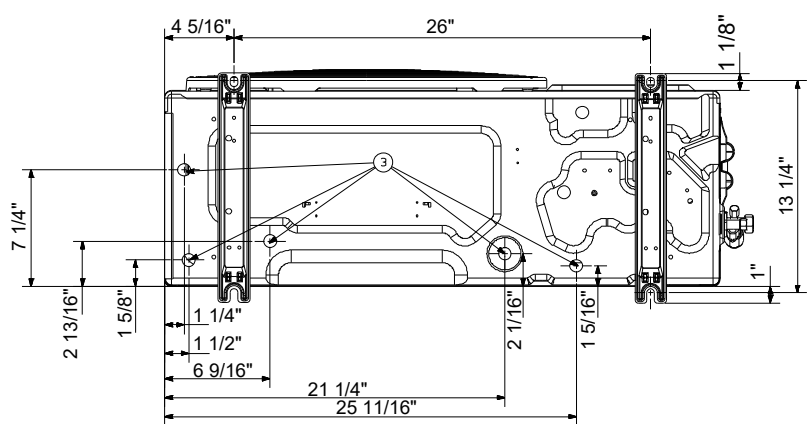
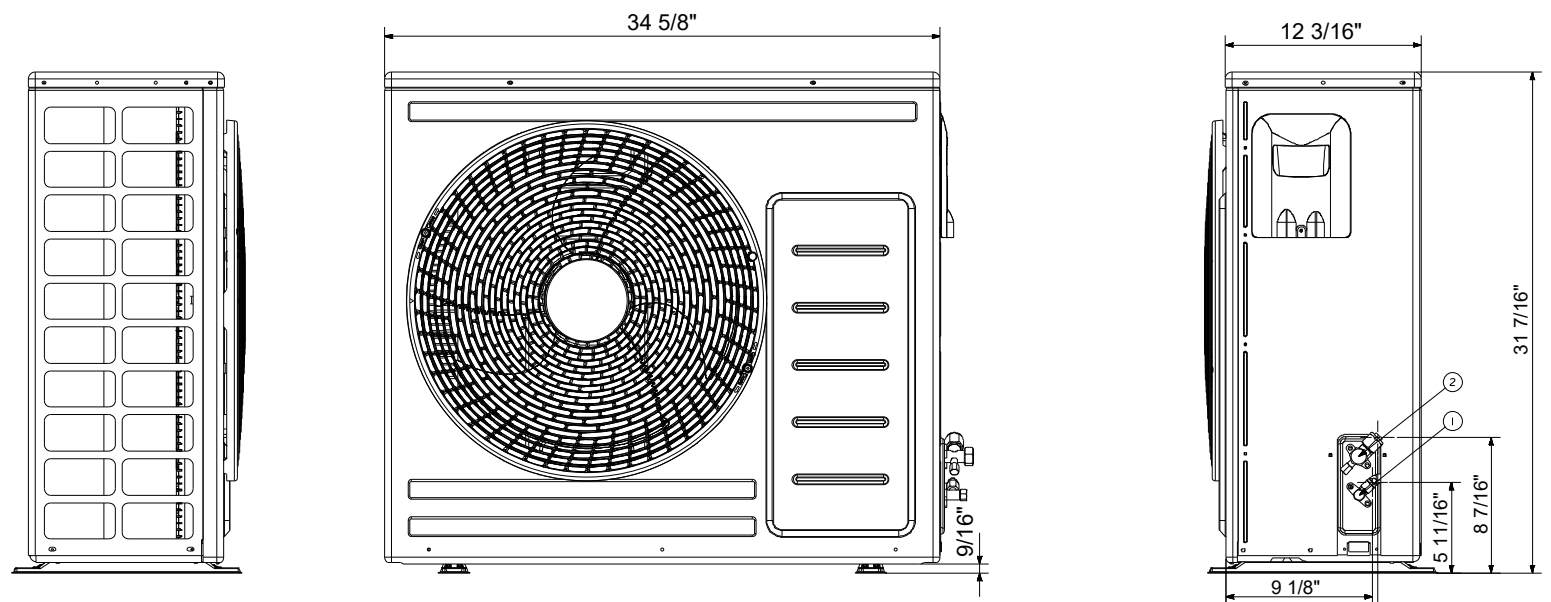
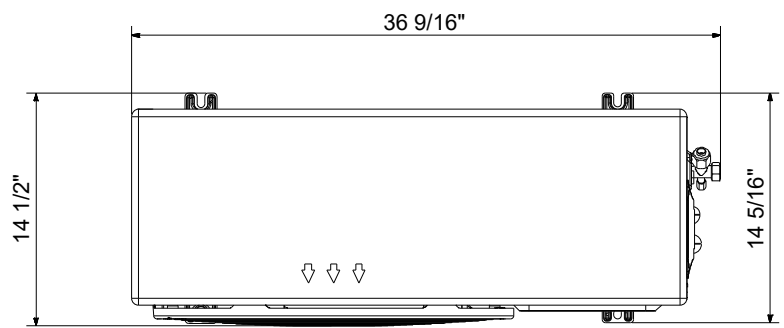

No.	Name	Description
①	Gas Pipe Connection	Ø 1/4" Flare
②	Liquid pipe Connection	Ø 5/8" Flare
③	Drain Hole	-